

LED-TECH.DE

OPTOELECTRONICS



LED-TECH.DE CREE MP-L Series

CREE MP-L EasyWhite (warm white)



The XLamp MP-L EasyWhite eliminates traditional chromaticity binning and maximizes lumen density, enabling luminaire and bulb retrofit manufacturers to deliver consistent color and required light output to the target end user.

XLamp MP-L EasyWhite LEDs reduce LED-to-LED color variation to within a 4-step MacAdams ellipse around the desired color temperature, which is 75% smaller than the total area of the corresponding ANSI C78.377 color region.

The XLamp MP-L EasyWhite LED is the perfect choice for lighting applications where high luminous flux output is required from a single, small point source. Examples of specific applications include:

- commercial/retail display spotlights
- LED retrofit bulbs
- indoor general illumination applications

{warning3}

Part Number: LT-1641

Viewing Angle: 125°

Emitting Color: warm white

Lumen typ.: 800 mcd

Kelvin typ.: 3000 mcd

mA typ.: 150 mA

mA max.: 250 mA

V typ.: 25 V

V max.: 27.5 V

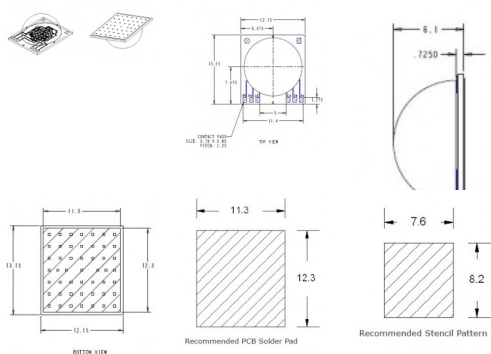
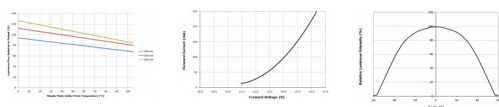

CREE MP-L EasyWhite (daylight white)



Part Number: LT-1643

Viewing Angle: 125°

Emitting Color: daylight white

Lumen typ.: 900 mcd

Kelvin typ.: 4000 mcd

mA typ.: 150 mA

mA max.: 250 mA

V typ.: 25 V

V max.: 27.5 V

The XLamp MP-L EasyWhite eliminates traditional chromaticity binning and maximizes lumen density, enabling luminaire and bulb retrofit manufacturers to deliver consistent color and required light output to the target end user.

XLamp MP-L EasyWhite LEDs reduce LED-to-LED color variation to within a 4-step MacAdams ellipse around the desired color temperature, which is 75% smaller than the total area of the corresponding ANSI C78.377 color region.

The XLamp MP-L EasyWhite LED is the perfect choice for lighting applications where high luminous flux output is required from a single, small point source. Examples of specific applications include:

- commercial/retail display spotlights
- LED retrofit bulbs
- indoor general illumination applications

{warning3}

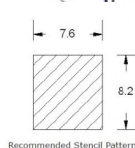
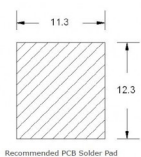
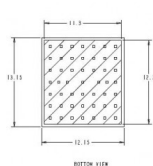
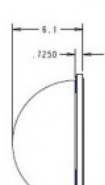
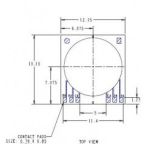
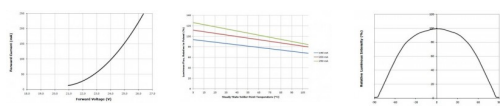

Imprint



LED-TECH.DE optoelectronics Showroom

Director: Stefan Lenz

Am Schürmannshütt 38B

D-47441 Moers

Phone: (+49) 2841 / 97 91 7-0

Fax: (+49) 2841 / 97 91 7-29

Further we want to point at pictures, graphics and descriptions as well as the pagelayout itself which are all subject to copyright. Every offence will be prosecuted.

All mentioned prices are to be understood as gross prices including the value added tax (TAV). All offers are subject to prior sales and without commitment. Delivery times are to be understood from date of receipt of order. Mistakes and changes in prices are always reserved.



